

HAPRO MANUAL



SUGGESTED SPECIFICATIONS

Crank operated manual projection screen. Suitable for wall and ceiling mounting with the supplied flexible metal mounting brackets (50cm). The steel square casing (11,8 x 11,8 cm) is galvanised on the inside and on the outside powder coated with a matte structure coating (RAL 9016). The grey end caps close the casing on both ends. The triangular slat bar closes the bottom of the casing completely. The screen surfaces are flame retardant and seamless. The projection surfaces have a 5 cm. border all around with the Video-, HDTV, and Wide format. The standard format (1:1) has a black border on both sides (width $\leq 240\text{cm} = 2.5\text{cm}$ and $> 240\text{cm} = 5\text{cm}$). The projection fabrics have a black backing. Standard a crank is supplied. The projection screen is CE marked and satisfies the strictest quality and safety requirements.

SCREEN SURFACES

All screen surfaces are seamless.

Matte White; Gain 1.0, viewing angle 120°, Flame retardant, max. height 300 cm, max. width 300 cm.

Datalux; Gain 1.5, viewing angle 70°, Flame retardant, max. height 240 cm, max. width 300 cm.

High Power; Gain 24 viewing angle 60°, Flame retardant, max. height 200 cm, max. width 240 cm.

DIMENSIONS (SELECT ONE OF OUR STANDARD SIZES AND ENTER THE REQUIRED)

Aspect Ratio	Overall Dimensions	Viewing Area	Nominal Diagonal		Case (RAL 9016)			Weight	Screen Surfaces		
	h x w cm	h x w cm	cm	inches	L1 (mm)	L2 (mm) max.	L3 (mm)	in kg	Matte White	Datalux	High Power
4:3	138 x 180	126 x 168	210	83	1915	929-1729	1820	18			
4:3	153 x 200	143 x 190	238	94	2135	1149-1949	2040	20			
4:3	168 x 220	158 x 210	263	103	2335	1349-2149	2240	23			
4:3	183 x 240	173 x 230	288	113	2535	1549-2349	2440	25			
4:3	213 x 280	203 x 270	338	133	2935	1949-2749	2840	29			
4:3	228 x 300	218 x 290	363	143	3135	2149-2949	3040	31			
1:1	160 x 160	151 x 151			1715	729-1529	1620	17			
1:1	180 x 180	173 x 173			1915	929-1729	1820	18			
1:1	200 x 200	195 x 195			2135	1149-1949	2040	22			
1:1	220 x 220	215 x 215			2335	1349-2149	2240	24			
1:1	240 x 240	230 x 230			2535	1549-2349	2440	28			
1:1	280 x 280	270 x 270			2935	1949-2749	2840	32			
1:1	300 x 300	290 x 290			3135	2149-2949	3040	36			

CUSTOM SOLUTIONS

Give exact the sizes of the projection screen you need:

Viewing size: _____ Height (cm.) x _____ width (cm.) Surface: _____

Border top: _____ (cm.) Border bottom: _____ (cm.)

Border left: _____ (cm.) Border right: _____ (cm.)

RAL color case and plastic parts: RAL _____

Screen fabric mounted reversely

Crank mounted on the right side

Remarks: _____

www.projectascreens.com/screendesigner

ACCESSORIES FOR MOUNTING

- Ceiling brackets (100 cm.)
- Set extension brackets (75 cm.)
- Set extension brackets (30 cm.)
- Set extension brackets (10 cm.)
- Set wall clamps
- Bracket kit for easy mounting in soffit

DIMENSIONS

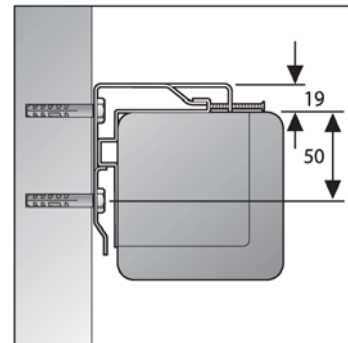
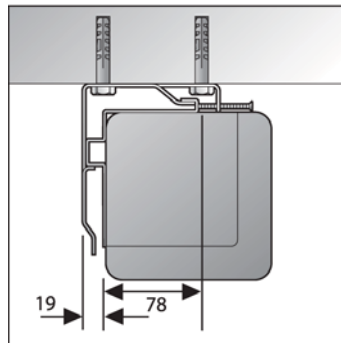
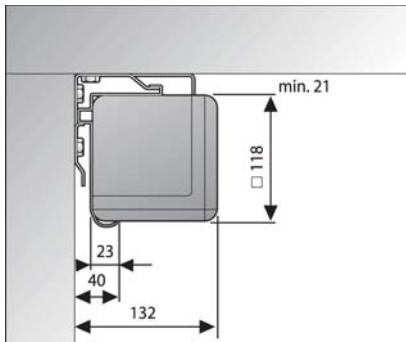

INSTALLATION

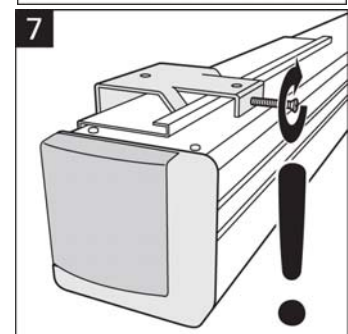
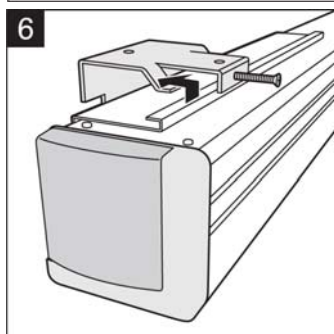
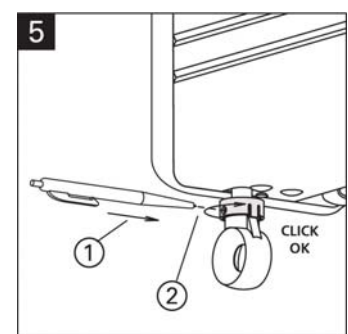
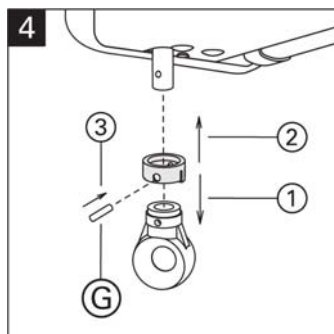
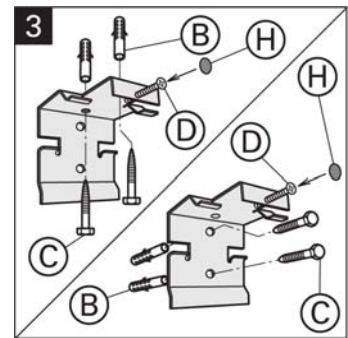
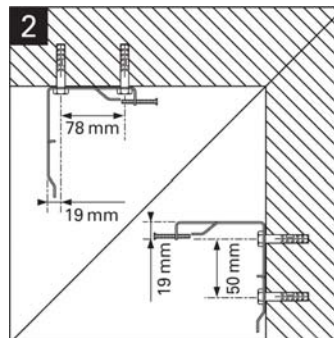
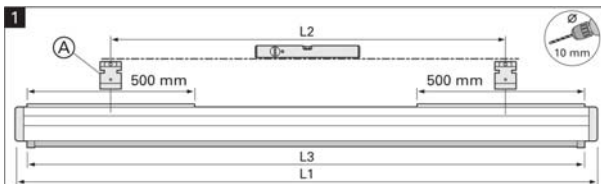
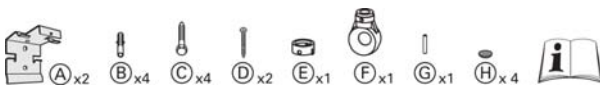

Project:	_____
Architect:	_____
Phone:	_____
Contractor:	_____
Phone:	_____
Supervisor:	_____
Phone:	_____
Supplier:	_____
Date:	_____
Revised:	_____