

Quick mounting

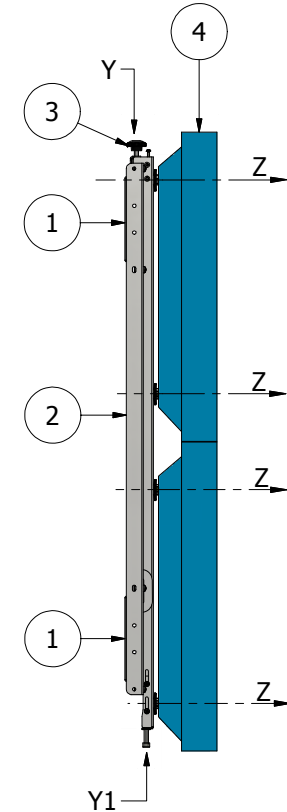
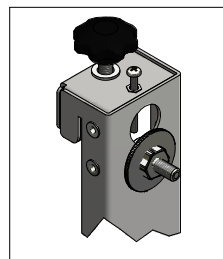

**Specifications**

- Screen Array Configuration : 1x2
- Orientation: Lendscape
- Adjustments (Y) Micro-Adjustments 10mm.
- Adjustments (Y1) Micro-Adjustments 24mm.
- Adjustments (X) Adjustments +/- 132mm.
- Adjustments (Z) Adjustments +/- 7mm.
- Mounting Pattern Vesa 400x400mm./400x600mm.
- Typical Screen Sizes: 46" - 47"
- Weight Capacity: 30 Kg to Screen
- Galvanized steel shets

POS.	QTY	DESCRIPTION
1	2	OMEGA L=980
2	2	VERTICAL ANGULAR
3	2	LCD BRACKET
4	2	SCREEN 46" / 47" VESA 400x400 / 400x600